

Crosby® Grommet Shackle

Load Rated®



APPLICATION INSTRUCTIONS
SEE PAGE 89 OF THE GENERAL CATALOG

G-2170 GROMMET SHACKLE



Scan our QR Code with your smart device to visit the online flyer.

- All sizes Quenched and Tempered for maximum strength.
- All sizes cast alloy steel.
- Sizes 300 metric tons and smaller are proof tested to 2 times the Working Load Limit.
- All ratings are in metric tons, embossed on side of bow.
- G-2170 bows are furnished Dimetcoted and pins are Dimetcoted, then painted red.
- All sizes are RFID Equipped in bow and pin
- Designed for use with single or double large diameter grommets.
- Extra large sling contact area improves efficiency of the grommet sling.
- Shackles utilize new **CrosbyEasy-Loc** bolt system
- Large machined flat on ears that can be drilled and tapped for adapting other accessories.
- HR-1000 Hoist Ring in Bow available for easy transporting
- Provides a bearing surface that is at least 5 times that of a round shackle.
- Increases usable sling strength minimum of 60% and greatly improves life of grommet slings.
- Bow and bolt are certified to meet charpy impact testing of 42 joules (31 ft-lbs.) min. ave. at -20 degree C (-4 degree F).
- All 2170 shackles are individually proof tested and magnetic particle inspected. Crosby certification available at time of order.
- Shackles requiring ABS, Lloyds, and other certifications are available upon special request and must be specified at time of order.
- All 2170 shackles can meet requirements of DNV Standard for Certification of Lifting Appliances upon special request and must be specified at time of order.
 - Serialization / Identification
 - Material Testing (Physical / Chemical / Charpy)
 - Proof Testing
- Look for the Red Pin®....the mark of genuine Crosby quality.

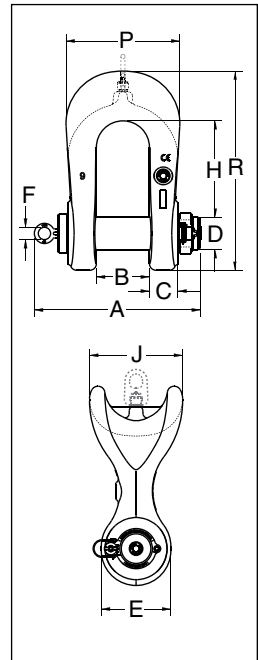

G-2170 Crosby® Grommet Shackles

Working Load Limit (t)*	Stock No.	Weight Each (lbs.)	Dimensions (in.)										Effective Body Diameter
			A	B +/- .025	C	D +/- .02	E	F	H	J	P	R	
75	1022075	113	14.08	4.13	2.39	2.75	5.50	1.19	7.77	7.50	9.50	16.20	11.25
125	1022084	176	16.05	5.13	2.75	3.15	6.72	1.19	9.31	9.00	11.00	19.25	13.50
200	1022093	368	19.13	5.91	3.39	4.12	9.00	1.75	11.64	12.90	13.63	25.01	18.45
300	1022100	686	22.44	7.38	4.30	5.25	11.13	1.75	15.20	15.50	17.00	31.82	22.75
500	1022119	1666	30.38	9.84	6.00	7.09	13.75	-	19.72	20.00	23.00	41.44	30.00

* Sizes 75-300 metric tons are proof tested to 2 times the Working Load Limit. 500 metric ton proof tested to 1.33 times Working Load Limit. Ultimate Load is 5 times the Working Load Limit. For Working Load Limit reduction due to side loading applications, see page 91.